

Wave Flexi-Link modules

Total system heights

Midi 229 cm / 90.2"

Starter kit IS-W-82-S

Extension kit IS-W-82-E

Maxi 249 cm / 98.0"

Starter kit IS-W-83-S

Extension kit IS-W-83-E



Starter kit complete with:
2 post sets, 2 feet, 1 Wave Flexi-Link,
2 sets corner trim, 1 set kicker and hanger



Extension kit complete with:
1 post set, 1 foot, 1 Wave Flexi-Link,
1 set kicker and hanger

Magnetic tape for graphic panels are **not included**.

Accessories

Padded case on wheels

Holds up to a **6 section** Wave system.
Item IS-TC-01-MB



Small graphic tube

to be attached to frame case
Holds up to **6 panels**,
Item IS-0850-RTS-S-MB



Large graphic tube

with handle and shoulder strap.
Holds up to **9 panels**,
Item IS-0850-RTB-S-MB

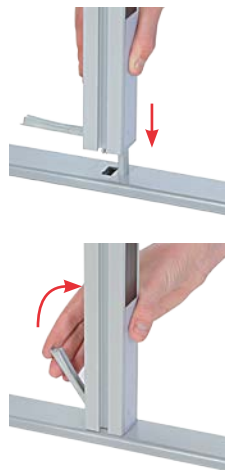

1 Begin by attaching the foot on the base post. Mount the stem on the foot into the front slot and lock the FASTclamp.



2 Insert the Wave Flexi-Link in the groove on the base post and push down.



3 Mount the extension post on top of the base post.



4 If you want **Maxi** height, add a short extension post before you mount the top post.



5 Complete the post with a top post section with the plastic top hub.



6 Follow these same steps for the second post in the starter module. The starter kit is now ready for a graphic panel.



7 Now you can add an **Extension Module** onto the starter section just built. Create a foot+base post+Flexi-Link assembly as before, then insert the link into a base post of the starter module and press down into place.



8 Follow the procedures shown above to build the new post to the height of the starter section. Add more modules as desired.



9 When the Wave wall is complete, finish each end by placing a set of 3 corner trims on the exposed magnets of the post.

Corner trims (see reverse side)

Graphic production and corner trim

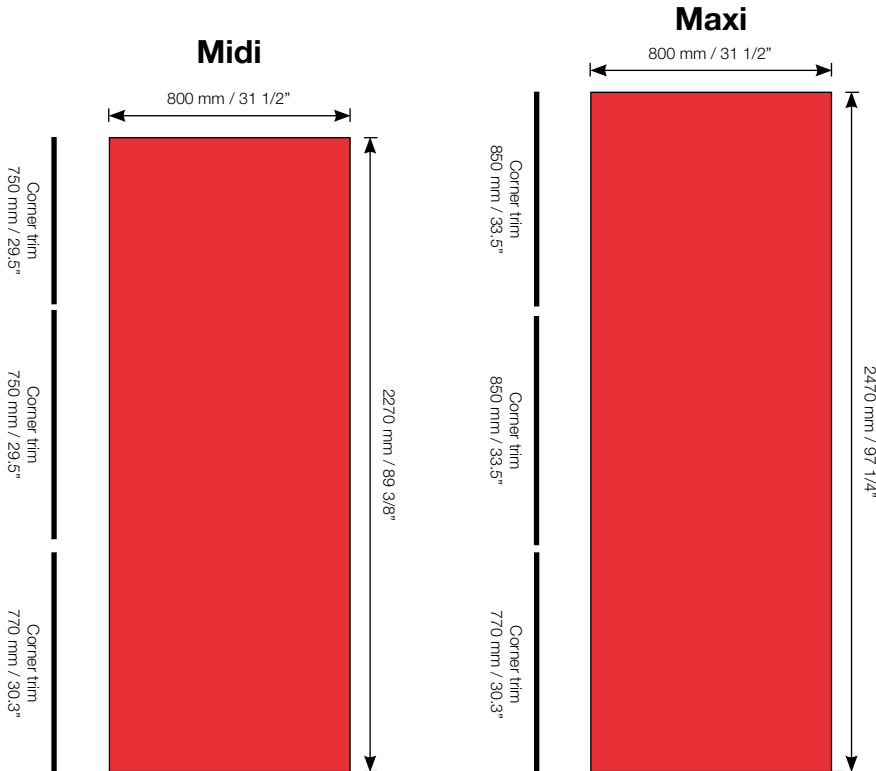

A template for the graphic panel production can be downloaded at:
<http://markbricdisplay.net/imagebank/PT-general.html>

Graphic panel attachments

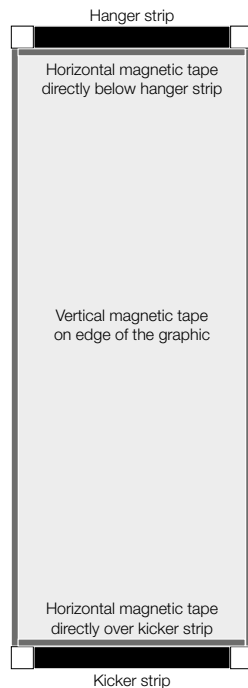

Printer material

We recommended the following material:

Poster paper: 180 gr / 0.4 lb.

The printed graphic panels must be laminated before use.

Front side: 125 microns (0,125 mm) / 0.005"

Reverse side: 250 microns (0,250 mm) / 0.010" stop light"

Polyester film: 330-370 microns (0,350 mm) / 0.013-0.015"

Top laminate: 125 microns (0,125 mm) / 0.005"



Kicker



Hanger

Mounting of Kickers and Hangers

Kickers and hangers to be fixed at the bottom and at the top of the graphic panels (reverse side).

Mounting of Magnetic Tape

Magnetic tape to be fixed **horizontally** directly over/under kicker/hanger strip. Magnetic tape to be fixed **vertically** along each side of the graphic panels.

IMPORTANT Carefully mount the magnetic tape slightly inset from the edge of the graphic panel by approximately 0,25 mm / 0.010". Once mounted, a very thin straight white line should show between the edge of the graphic and the outside edge of the magnetic tape. Do not exceed 0,5 mm / 0.020".

Application Techniques

To obtain optimum adhesion, the bonding surfaces must be well unified, clean and dry. Typical surface cleaning solvents are isopropyl alcohol/water mixture (rubbing alcohol) or heptane.

Note: Be sure to follow solvent manufacturer's precautions and directions for use when using solvents.

Accessories

Kickers & Hangers

(incl. for the first set of panels)
800 mm / 31 1/5"

Item IS-800-KHN

Magnetic tape (not incl.)

12 mm/0.5" A tape, 30 m / 98 ft. Item 82281

Each panel needs:

Midi 6,2 m / 21 ft.

Maxi 6,6 m / 22 ft.